

Community Facilities

With our combination of skills in both planning & landscape architecture, Inukshuk has an ability to see the bigger picture, ensuring that function is never sacrificed for fluff.

Our approach to facility planning is analytical as well as aesthetic, with pleasing & comfortable design solutions backed up by solid research & innovation.

Whitehorse Public Safety Building

Inukshuk developed a landscaping design concept for this unique, high profile site.

The plan incorporates two major public statues and several city endorsed objectives. The project team confronted a number of design challenges including issues related to entry, arrival and site circulation, grading, site drainage, integration with an adjacent existing snow dump and space use functionality.

Client: City of Whitehorse



Haines Junction Block 39 Landscape Plan

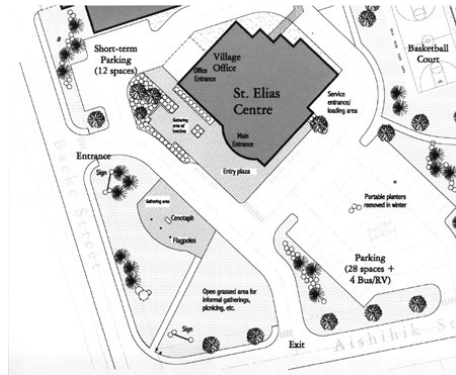

Block 39 is the “heart” of the village, containing the municipal offices, the new convention centre, a community centre and key recreational facilities such as the pool and arena. Inukshuk developed a landscape plan for the area that could be undertaken in phases, and that reconciled functional requirements such as the need for adequate parking with the desire to highlight the natural beauty of the surroundings.

Client: Village of Haines Junction



Inukshuk Planning & Development LTD.

207 Elliott Street
Whitehorse, Yukon Y1A 2A1
Phone: (867) 667-4759
Fax: (867) 667-4020
E-mail: info@inukshukplanning.ca

www.inukshukplanning.ca

Grey Mountain Cemetery Expansion

The unconventional circular design for the expansion area recalls the ripples left when a pebble hits the water, evocative of the impressions we all make in the lives of others while we are here. A first for the Yukon, the expansion also includes a special area for the interment of children, recognizing the special grief and need to recognize and celebrate life that happens with the passing of a child.

Client: City of Whitehorse

