

Quarry Development & Reclamation Planning

Aggregate is always needed. Our challenge is to protect the resource, minimize the development footprint and ensure that reclamation results in a viable end use.

We work with governments, producers and the public to expedite land use approvals, produce defensible operational plans and develop practical land reclamation strategies.



Inukshuk Planning & Development LTD.

207 Elliott Street
Whitehorse, Yukon Y1A 2A1
Phone: (867) 667-4759
Fax: (867) 667-4020
E-mail: info@inukshukplanning.ca

www.inukshukplanning.ca

Development & Reclamation Standards for Yukon Pits & Quarries

Inukshuk produced an updated guide on development and reclamation standards for Yukon pits and quarries. The manual helps anyone planning to develop a pit or quarry to understand the application requirements, review process and operational requirements, along with their subsequent reclamation responsibilities.

Client: DIAND



Crow Mountain Quarry

Inukshuk coordinated preparation of the project description and environmental screening to the standards expected to be required under the Yukon's new environmental and socio-economic assessment legislation. The project was designed to establish the benchmark for future submissions and demonstrate the First Nation's commitment to apply the same standards to its own projects.

Client: Vuntut Gwitchin First Nation



McLean Lake Quarry Expansion

Inukshuk assessed the impacts associated with quarry expansion and devised a development plan to accommodate public concerns and provide reclamation guidelines. Public consultation methodology included a GIS generated terrain model to illustrate site development and visual impacts.

Client: Government of Yukon

Quarry Development & Reclamation Planning

Aggregate is always needed. Our challenge is to protect the resource, minimize the development footprint and ensure that reclamation results in a viable end use.

We work with governments, producers and the public to expedite land use approvals, produce defensible operational plans and develop practical land reclamation strategies.



Inukshuk Planning & Development LTD.

207 Elliott Street
Whitehorse, Yukon Y1A 2A1
Phone: (867) 667-4759
Fax: (867) 667-4020
E-mail: info@inukshukplanning.ca

www.inukshukplanning.ca

Stevens Quarry Development Plan

The Stevens Quarry Development Plan covers a 119.5 ha site situated between the Alaska Highway and the Takhini River in

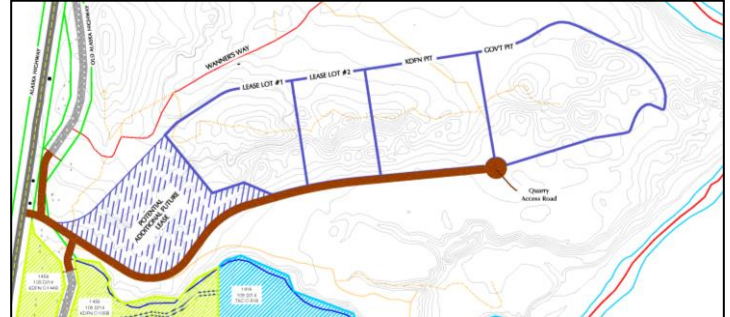

Whitehorse. The plan was prepared to provide a viable aggregate source for private industry, the City of Whitehorse, Yukon Government and Kwanlin Dün First Nation. The plan details how extraction should proceed in order to minimize impacts on adjacent land uses and includes pit operation and reclamation guidelines.

Client: City of Whitehorse/Government of Yukon

Annie Lake Trucking Quarry Operation & Rehabilitation Plan

The reclamation strategy incorporates final pit closure recommendations and site reclamation guidelines. The plan was divided into two phases, Phase 1 involving reclamation work around the periphery of the lease, and Phase 2 involving site re-grading and slope stabilisation following closure of quarry operations. The reclamation plan allows for integration of the Annie Lake lease into a park and provides the basic infrastructure needed for development at virtually no cost to the municipality.

Client: Annie Lake Trucking Ltd/Government of Yukon



Ear Lake/South Access Quarry Reclamation Plan

This project involved updating the 1980 Reclamation Plan to include reclamation performance measures to be attached to lease renewals. Inukshuk facilitated a design charrette to allow direct industry and public participation in plan preparation as the quarries are situated along the main access

road into Whitehorse.

Client: Government of Yukon